

DANS LE BUT CONSTANT D'AMELIORER SES PRODUITS, Amphenol Socapex SE RESERVE LE DROIT D'EN MODIFIER TOUTE COTE OU CARACTERISTIQUE.  
IMP 036 A

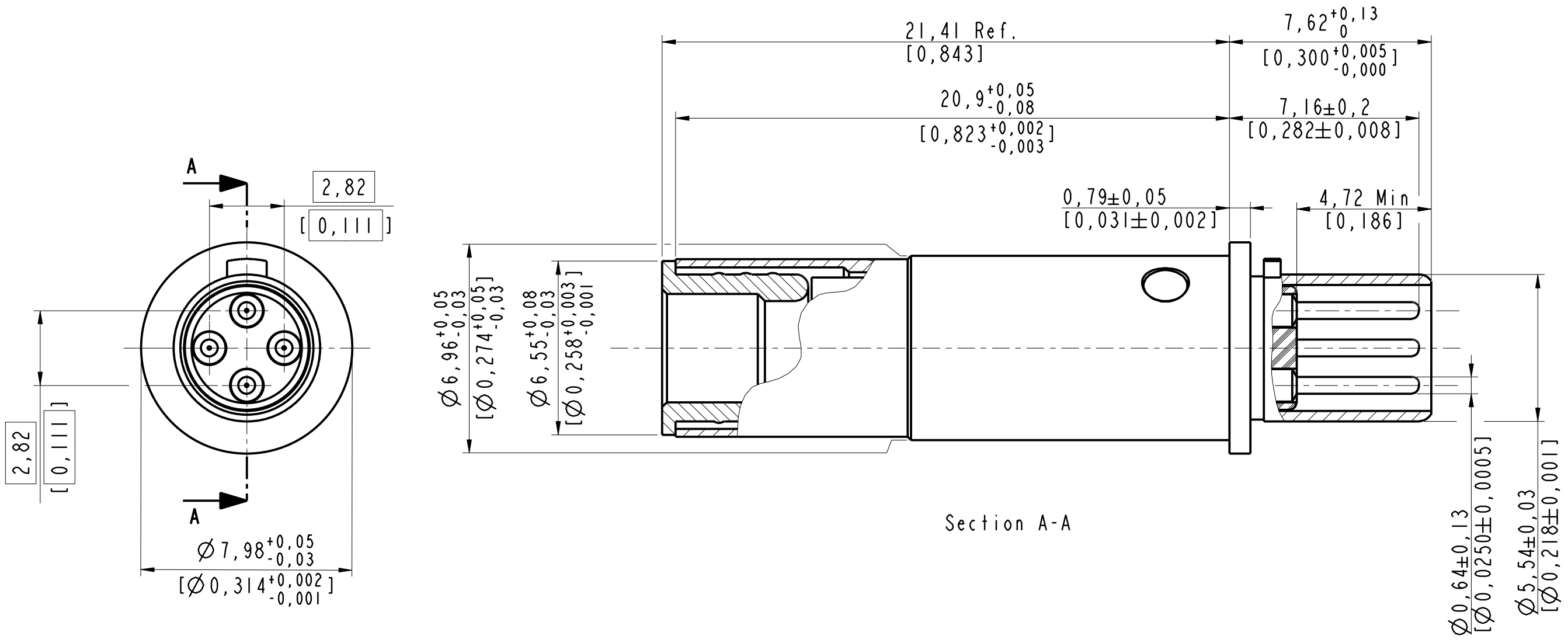

Section A-A

## Contact Pin Quadrax for electrical connector Type D38999 Serie I & III Part Number : 900330

**Notes:**

1. Mates with D38999 quadrax sockets 900338
2. Crimping Tools:  
Outer contact- M22520/5-01 tool, M22520/5-45 die set (hex closure A)  
Inner contacts- M22520/2-01 tool, Daniels K709 (M22520/2-37) Positioner
3. Terminates quadrax cable tensolite NF24Q100 (100 ohm) or equivalent
4. Contacts meet the envelope dimensional requirements of M39029/90
5. Dimensions in bracket : Dimensions in inch

MODIFICATIONS	A	Plan original	ECHELLE	Amphenol Socapex BP 29 - 74311 THYEZ CEDEX	DESSIN: P.Pawar	LE:05/09/13
			6		TECHNIQUE: L.Lagrange	LE:05/09/13
					A	
					173-PLC-1175-00 1/1	